



Zetland, NSW

8/2 Leyland Grove

**ellouise
tyrrell**

PROPERTY MANAGEMENT
STRATA MANAGEMENT

Modern three level terrace

Spreading over three thoughtfully designed storeys,
3 bedrooms

main bedroom with ensuite and huge terrace

2nd bedroom -has own balcony

quiet end terrace location

- Modern well appointed combined living and dining spaces

- Well designed kitchen with stainless steel appliances

- Quiet cul de sac

- Separate front and rear alfresco entertaining decks

- Spacious main bathroom with bath

- Communal garden at rear

- separate study area

- Double tandem parking

- Pet friendly

- Moments from East Village

\$1,350 pw

Bedrooms: 3

Bathrooms: 2

Carspaces: 2

Contact: Norman Blundell
0405 892 073

Type: Terrace

Date Available: 15/05/2023

Leased Date: 20/05/2023

Bond: \$5400

<https://www.etpm.com.au>

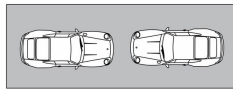

UNDERCOVER SECURITY
CARSPACES

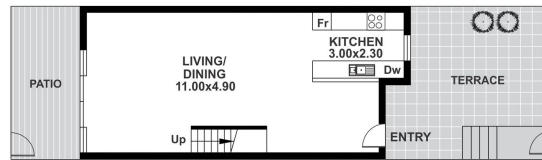
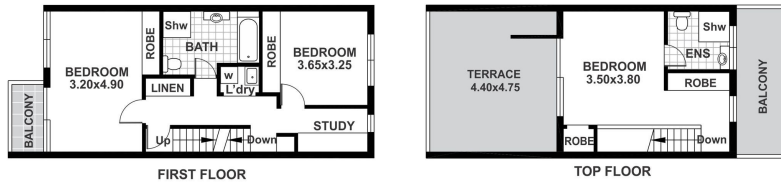

GROUND FLOOR

0 1 2 3 4 5

This diagram is for illustrative purpose only. All reasonable care has been taken in the preparation, but no warranty is given to the accuracy of the information. This document does not constitute any part of any offer or contract. Dimensions shown are approximate only. Prospective purchasers must rely on their own enquiries.



CLARK
Estate Agents

8/2 Leyland Grove, Zetland

Plans shown are only indicative of layout. Dimensions are approximate.

Zetland, NSW
8/2 Leyland Grove